



*One&Only*

MANDARINA

*Mexico*

MEETINGS AND EVENTS

*One&Only*

MEETINGS AND EVENTS

*“I took a walk in  
the woods and  
came out taller  
than the trees”*

HENRY DAVID THOREAU



An aerial photograph of a coastline. On the right, a dark green, forested hill slopes down to a sandy beach. The ocean is visible, with white surf breaking near the shore. The water transitions from a light turquoise near the beach to a deep, dark teal further out. The overall lighting suggests a bright, sunny day.

MEET  
YOUR  
DREAMS









---

*One&Only*

WELCOME

WHERE STYLE  
& ADVENTURE

MEET

On a rare undeveloped coastline flanked by rainforest-clad mountains and vast Pacific Ocean is a haven like nowhere else.

A one-of-a-kind resort entwined with the environment, where adventure, style, and indulgence await you and your guests. Where unique and private spaces, immersed in flora and spectacular ocean views, surround you in the refreshing energy of nature and the buzz of a glamorous lifestyle. Inspiring productivity, discovery, team bonding, and memorable moments; embraced by our signature warm service and renowned One&Only flair.

---













---

*One&Only*

DESTINATION

## UNRIVALLED LOCATION

Woven seamlessly into the dramatic vistas of Mexico's most awe-inspiring coastal rainforest, One&Only Mandarin is set within a secluded yet expansive sanctuary in Riviera Nayarit. Travel just 45 minutes from Puerto Vallarta International Airport on palm-clad roads, past quaint coastal towns and through pineapple fields to arrive at One&Only Mandarin by luxury transportation. This well-connected hub offers direct flights from a host of U.S., Mexican, and Canadian cities - flights from Los Angeles are a quick 3-hour trip.

---









*One&Only*

DESTINATION

## REDEFINING TAILOR-MADE

In this unspoiled corner of the world, One&Only Mandarin delivers elevated events and incentive trips, from the simple to the elaborate, always unique.

Against unforgettable backdrops, you can explore endless bespoke possibilities, from locations and styling to menus, group adventures, and everything in between. What's more, our experienced Event Planners will take on every aspect, so you can relax and enjoy the show. With passion, creativity, and exacting attention to detail, we'll help design and execute an unrivalled affair.













---

*One&Only*

RESORT

## EVERYTHING WITHIN REACH

One of the best parts of hosting an event at One&Only Mandarin is having access to a vibrant destination that will captivate your guests.

On resort, an array of chic spaces invite them to unwind, from soft white sands and swimmable waters to a choice of family-friendly and adult-only swimming pools, scenic restaurants and bars, an incredible kids' club zone, and a divine One&Only Spa. Just beyond lies the exclusive Mandarin community, where miles of nature trails, pristine sports grounds, outdoor pursuits, Canalan Beach Club, and the lively Mandarin Polo & Equestrian Club add further layers of entertainment. And then there's our spectacular Mexican locale which we curate and bring to life, especially for you.

---









---

*One&Only*

EAT

## FEAST FOR THE SENSES

Overlooking dramatic vistas of Pacific Ocean and jungle, dining at One&Only Mandarina's three world-class restaurants is always something to behold.

Championing local, seasonal, and organic ingredients, our flavours are equally spectacular. With Pan-American and Mediterranean specialities, fresh seafood grills, and modern Mexican creations by celebrity Chef Enrique Olvera, there's an array of temptations complemented by worldly wines and artisanal cocktails. From breakfast at Alma to a chic beach barbecue or refined dinner on the starlit terrace of a Grand Villa, we can also arrange bespoke private dining concepts to captivate your guests.

---













---

*One&Only*

SPA

## IMMERSE IN WELLBEING

Between work and play, One&Only Mandarina is a peaceful sanctuary for your guests to reset and transform, inspired by a principle of 'oneness' with nature. There's a state-of-the-art Fitness Centre with dynamic classes for all abilities, a scenic Aura Deck for heightened practice and meditation, plus a wealth of fitness challenges and sports that we can arrange to stimulate your group.

For something more soothing, set beneath a canopy of towering Higuera trees, our One&Only Spa offers a word of holistic treatments with award-winning natural skincare brand, Tata Harper. Indulge in pure relaxation bathing in the healing vitality pool, and relishing an energizing hydrotherapy circuit with cold plunge pools, steam, and sauna overlooking the jungle. The ultimate backdrop for team bonding, or moments of private rejuvenation between events.

---













---

*One&Only*

ROOMS & SUITES

## A WORLD OF ADVENTURE

Whether on an organised group expedition or enjoying independent down-time, our energized environment calls you to adventure. In vast Pacific Ocean, venture out for a day of sun-soaked yachting, whale watching, or fishing with a local legend. Through unspoiled nature, zipline through the canopy, hike miles of rainforest, cycle over flatlands, or kayak the calm waters, with optional 'competition' thrown in.

Across Mexican landscapes – uncover archeological wonders, national parks, bustling markets, and iconic surf spots. And dabble in an array of hands-on or mindful activities that illuminate secrets of Mexico. From ancient meditations to cooking workshops, local spirit tastings and horse riding lessons at Mandarin Polo & Equestrian Club, you'll never be lost for inspiration.

---













*One&Only*

ROOMS & SUITES

## YOUR OWN PRIVATE SPACE

Inspired by the colours and textures of Mandarina, stylish eco-designer villas and treehouses are built to nature's blueprint, leaving the stunning surroundings completely undisturbed.

With ultra-chic interiors and generous space to relax under the emerald canopy, you can choose to reconnect around your private plunge pool with attentive host service or bask in quiet sun-soaked moments, secluded from the action. In our all-villa resort, every standalone space becomes a personal sanctuary and front-row seat to the theatre of rainforest and ocean.











EVENT VENUES

EVENT PAVILION

Choose a grand, classic feel for your meeting or event with our Salón Papelillo, an indoor ballroom named after a native tree found on the property. The adjacent al fresco courtyard is framed by lush rainforest greenery, perfect for atmospheric drinks or refreshing breakouts.

MAXIMUM CAPACITY:  
180 Guests

DINNER - SALÓN PAPELILLO:  
120 Guests

COCKTAIL RECEPTION - COURTYARD:  
60 Guests (standing only)

JETTY BEACH CLUB

Located down on the crystal shoreline where ocean laps powder sand, there's a natural energy for relaxation and celebration that's perfect for a dinner or cocktail reception.

MAXIMUM CAPACITY:  
70 Guests

DINNER:  
70 Guests

COCKTAIL RECEPTION:  
50-70 Guests

THE JETTY

Curving out into shimmering waters, The Jetty offers a striking and exclusive setting with 360 views of ocean and dramatic jungle coastline. Your attendees will be mesmerized during a pre-dinner toast as the sun sets behind jungle-clad mountains, and The Jetty comes alive with a crackling firepit.

MAXIMUM CAPACITY:  
50 Guests

COCKTAIL RECEPTION:  
50 Guests (standing only)

ALMA

Presenting elevated views over the vast ocean with greenery rising all around, Alma is a glamorous clifftop location for private evening functions including dinners and cocktail receptions with 'wow' factor.

MAXIMUM CAPACITY - POOL DECK:  
250 Guests

DINNER - POOL DECK:  
152 Guests

COCKTAIL RECEPTION - POOL DECK:  
250 Guests (standing only)

CARAO

Suspended atop the resort's southernmost peak with a mesmerising ocean backdrop and the most spectacular sunset vistas, Carao offers an intimate setting for pre-dinner sunset cocktails or private evening functions with your attendees.

MAXIMUM CAPACITY:  
80 Guests

DINNER - RESTAURANT:  
40 Guests

COCKTAIL RECEPTION - POOL DECK:  
80 Guests (standing only)

THE TREETOP

Nestled in the emerald cliffside and perched over ocean, The Treetop offers the ultimate setting for an intimate cocktail reception with mesmerising views of the Mandarin sunset.

MAXIMUM CAPACITY:  
25 Guests

CANALAN BEACH CLUB

A seaside retreat situated along a one-mile stretch of secluded, sandy beach. Canalan Beach Club provides a stunning, oceanside setting for a cocktail reception or dinner.

MAXIMUM CAPACITY:  
300 Guests

DINNER:  
300 Guests

COCKTAIL RECEPTION:  
300 Guests

MANDARINA POLO & EQUESTRIAN CLUB

Surrounded by the roaring ocean, a dramatic canopy and volcanic amphitheatre; this is a setting like no other for an event on the polo fields or under the roofed arena.

MAXIMUM CAPACITY:  
2,000 Guests

DINNER:  
1,500 Guests

COCKTAIL RECEPTION:  
400 Guests

SERVICES & ACTIVITIES

EVENT PLANNER

Your dedicated Event Planner will remain your constant support from the time of booking until you leave our shores. With infinite expertise, they will arrange and coordinate your every wish for the duration of all meetings, events, and incentives.

INCENTIVES & TEAM BUILDING ACTIVITIES

An undisturbed coastal rainforest affords plenty of creative inspiration to reward your attendees or build team spirit, and we can help you design a dynamic and unforgettable programme. Exploring miles of nature trails, making an authentic Mexican taco from scratch, enjoying a horseback lesson, or taking part in a jungle workout are just some of the stimulating possibilities. And nothing cultivates a sense of appreciation quite like a retreat to our One&Only Spa.

LEISURE TIME

In between events and activities, your guests can unwind in our host of exceptional spaces. Soaking up sun by our infinity pools or calm beachfront, exploring the rainforest at leisure, working up a sweat in the fitness studio or winding down with yoga or a holistic spa treatment.. it's all here and more in our resort's backyard.

ACCOMMODATION

TREEHOUSES

Perched in boughs and immersed in lush foliage, our eco-designer Treehouses celebrate ultra-stylish living, 12 metres above the ground. Indulge in standalone privacy and soak up the raw beauty of rainforest or Pacific views beyond your infinity plunge pool.

CLIFF VILLAS

Float in your own private plunge pool secluded by foliage, dine on your clifftop terrace, and relax within your spacious sanctuary where everything is carefully designed to blend with nature. Set upon the mountain top, these one-bedroom villas also offer views of rainforest or ocean.

GRAND VILLAS

Expansive indoor and outdoor living is the hallmark of our family- and group-friendly Grand Villas. With separate living and dining spaces, signature host service, and varied extras from hot tubs, swimming pools and outdoor rain showers to indulgent private pantries, you've discovered the height of resort living.

VILLA ONE

Positioned on a hilltop at the centre of the resort, tucked away in lush greenery, Villa One is the resort's most exquisite address, offering ultimate space and privacy. The expansive two-story, three-bedroom hideaway presents magnificent views of the Pacific Ocean and includes jaw-dropping social spaces, including a spa room, wine cellar, cinema, and more. Perfect for hosting an extra-special private event.

SIGNATURE VILLAS

Nestled high in the rainforest, with captivating ocean, beach and mountain views, our Signature Villas are secluded hideaways designed to accommodate larger groups. With endless room to roam, the expansive villas combine the comforts of home with the pampering of a resort featuring swimming pools, state-of-the-art gyms, gourmet kitchens, full-screen cinemas and expansive terraces.

DINING

CUISINE

For us, food is about much more than sustenance – it's a celebration and a passion, especially when it comes to your one-of-a-kind event. With access to our world class culinary team, you can co-create highly personalised and inventive menus bursting with flavor, from mouth-watering canapés and creative cocktails to decadent lunches, pristine picnics, and twilight dinners.

ALMA

Sample Pan-American, Mediterranean, and Mexican cuisines in a delicious fusion of flavour. With a seasonal, garden-to-plate ethos, each globally-inspired recipe still tells a story of Mandarin.

CARAO

Savour an extra-special high-altitude dining experience suspended on the cliffside, curated by award-winning celebrity chef Enrique Olvera with his artistic twist on authentic Mexican ingredients.

JETTY BEACH CLUB

Edging onto sand and calm Pacific Ocean, indulge all your senses in laid-back style with casual beachfront plates, including freshly-grilled catch of the day, connecting you with the waters beyond.

THE TREETOP

One&Only Mandarin's ethos of conscious living is brought to life at The Treetop, where you can enjoy cocktails made entirely from sustainable ingredients, plus delicious bar plates served amid greenery, perched over the sea.

ADDITIONAL INFORMATION

WEATHER

The sun shines almost every day of the year in Riviera Nayarit, with average temperatures in the low 80s Fahrenheit.

TRAVEL INFORMATION

Just north of Punta Mita, One&Only Mandarin nestles within an intimate new community set upon a rare undeveloped coastline along the Riviera Nayarit. Surrounded by coastal rainforest and protected Sierra del Vallejo Mountains, the resort is just 45 minutes from Puerto Vallarta International Airport by luxury transportation, so you can be on-site relaxing in no time.



*One&Only*

THE DETAILS

## CONTACT

For enquires or bookings contact  
one of our event managers  
[reservations@oneandonlymandarina.com](mailto:reservations@oneandonlymandarina.com)

One&Only Mandarin  
Carretera Federal Libre 200 Tepic-Puerto Vallarta,  
El Monteón, Municipio De Compostela, Nayarit,  
C .P. 63724, Mexico

Telephone +52 327 689 0100  
Reservations +1 855 270 2173

GDS CODES  
Amadeus OOPVROOM  
Sabre OO328103  
Galileo OOF5566  
Worldspan OOPVROM  
Pegasus OO9372  
Travelweb OO9372

@OOMandarina  
[oneandonlymandarina.com](http://oneandonlymandarina.com)





SEATING CAPACITY

EVENTSPACE	AUDITORIUM	CLASSROOM	U-SHAPE	BOARDROOM	CHEVRON THEATER STYLE	STANDING COCKTAIL	HIGHBOY COCKTAIL	BUFFET COCKTAIL	DINNER
Jetty Beach Club - Dining Area	-	-	-	-	-	50	30	-	24 existing setup
Jetty Beach Club - Pool Terrace	-	-	-	-	-	70	50	-	70 mix of rounds & imperial tables
Alma - Pool Deck	-	-	-	-	-	250	200	-	152 mix of rounds & imperial tables
Alma – North Pool Deck	-	-	-	-	-	40	40	-	24 round tables
Alma – South Pool Deck	60	-	-	-	-	160	160	-	136 mix of rounds & imperial tables
Carao - Restaurant	-	-	-	-	-	-	-	-	40 existing setup
Carao - Pool Deck	60	-	-	-	50	80	80	-	60
The Jetty	40	-	-	-	-	50	50	-	-
The Treetop	-	-	-	-	-	25	16	-	-
Salon Papelillo	120	60	40	40	60	180	160	-	120
Courtyard	42	24	-	-	42	60	60	-	40
Parota Boardroom	-	-	-	12	-	-	-	-	-
Polo Fields – Green Court	-	-	-	-	-	2,000	2,000	2,000	1,500
Polo – Roofed Arena	-	-	-	-	400	450	450	450	500
Organic Farm	-	-	-	-	85	100	100	100	80
Allora	-	-	-	-	-	40	40	40	30
Chukker	-	-	-	-	-	60	60	50	40
Canalan Beach Club	-	-	-	-	150	300	300	300	300
Canalan Beach Club Pool Deck						30	30	30	20

MEASUREMENTS

EVENTSPACE	TOTAL SQ. METERS	LENGTH (M)	WIDTH (M)	HEIGHT (M)	TOTAL SQ. FEET	LENGTH (FT)	WIDTH (FT)	HEIGHT (FT)
Jetty Beach Club	2,775.2 Interior: 358.4 Exterior: 2,416.7	41.72	20.26	3.44	9,105 Interior: 1,176 Exterior: 7,929	136.9	66.5	11.3
Alma	5,549.8 Interior: 1,409.4 Exterior: 4,140.4	Interior: 20.45 Exterior: 45.56	Interior: 10.94 Exterior: 24.93	3.38	18,208 Interior: 4,624 Exterior: 13,584	Interior: 67.11 Exterior: 149.5	Interior: 35.9 Exterior: 81'8	11.11
Carao	3342.7 Interior: 1,083 Exterior: 2,260	Interior: 50.07 Exterior: 16.79	Interior: 12.43 Exterior: 36.88	3	10,967 Interior: 3,553 Exterior: 7,414	Interior: 164.3 Exterior: 55.10	Interior: 40.8 Exterior: 121	9.9
The Treetop	213.36	8.59	7.68	2.62	700	28.2	25.2	8.6
The Jetty	430.98	30.90	4.32	-	1,414	101.4	14.2	-
Salon Papelillo	690.37	16.49	10.85	3.26	2,265	54.11	35.6	10.7
Courtyard	522.12	12.71	11.58	3.62	1,713	41.7	38	11.9
Parota Boardroom	111.86	7.12	4.08	3.35	367	23.5	13.4	11
Polo Fields	40,500.0	270.0	150.0	-	435,927.8	885.8	492.1	-
Polo – Roofed Arena	1,536.0	64.0	24.0	4.3	16,533.0	210.0	78.7	14.1
Allora	76.9	11.7	6.6	4.5	827.6	38.2	21.7	14.8
Chukker	172.2	14.0	12.3	3.7	1,853.5	45.9	40.4	12.1
Organic Farm (under the tree)	226.2	19.5	11.6	2.8	2,434.7	64.0	38.1	9.0
Organic Farm (esplanade)	236.7	19.4	12.2	-	2,547.5	63.6	40.0	-
Organic Farm (palapa)	29.6	7.8	3.8	2.5	319.0	25.6	12.5	8.2
Canalan Beach Club	4798.77	99.97	14.63	-	15,744	328	48	-



EVENT PAVILION FLOORPLAN - CLASSROOM

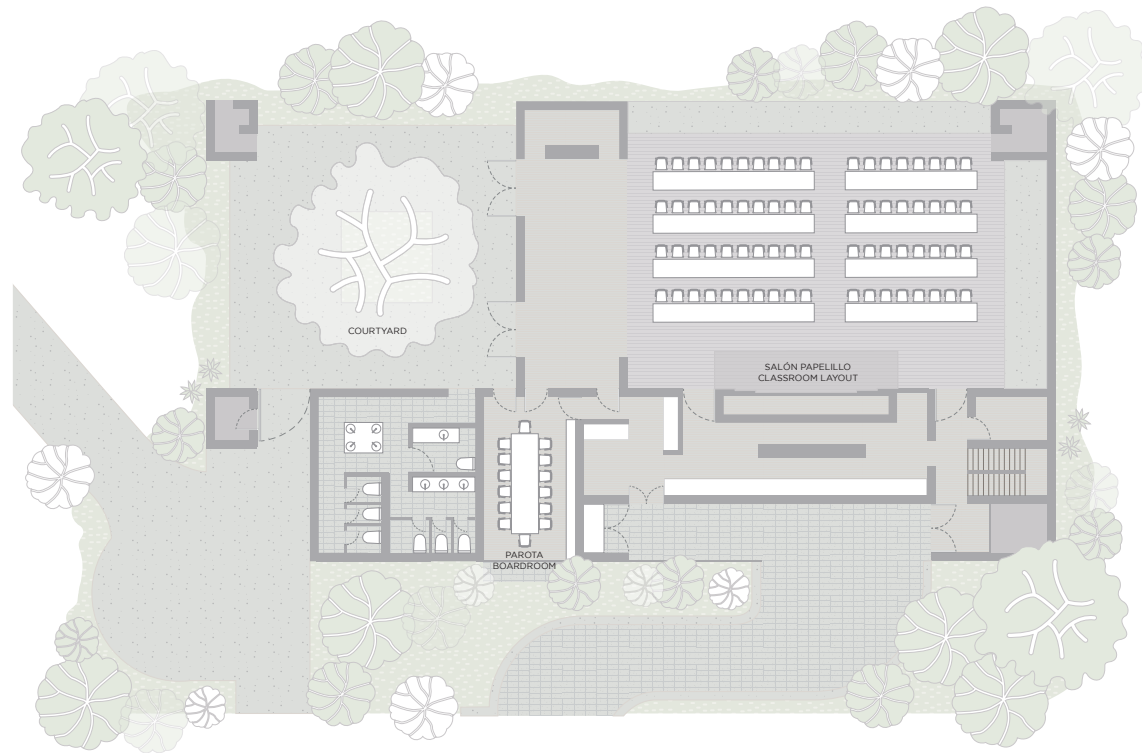

EVENT PAVILION FLOORPLAN - RECEPTION

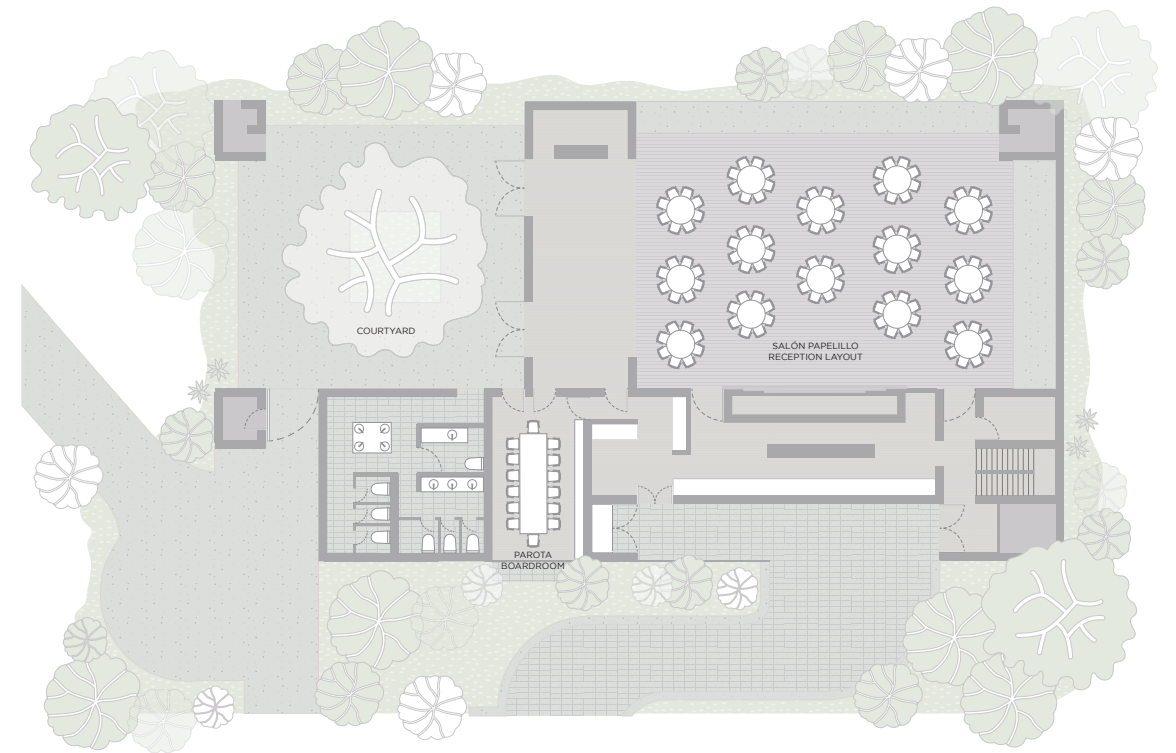



CARAO FLOORPLAN

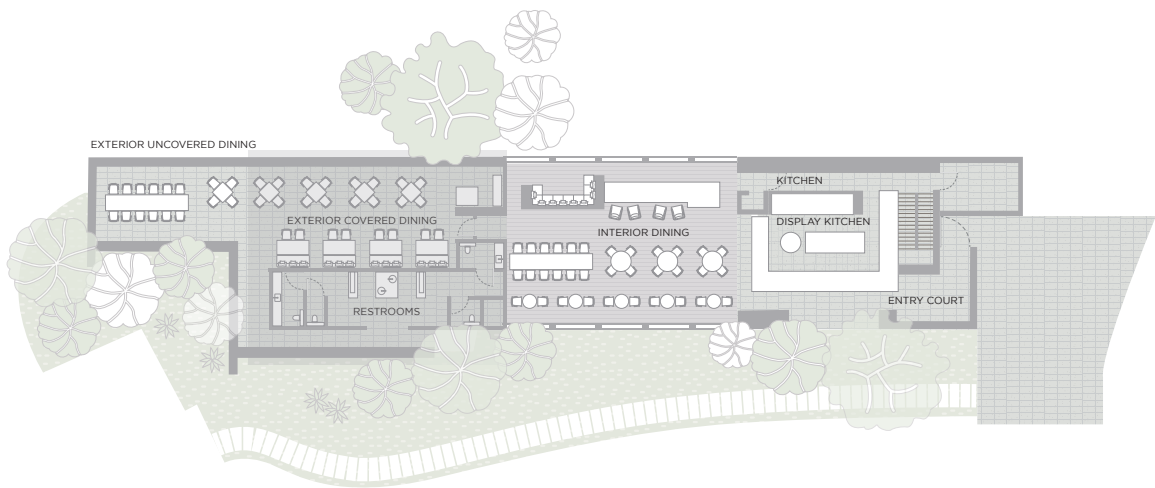

ALMA FLOORPLAN





## JETTY BEACH CLUB FLOORPLAN

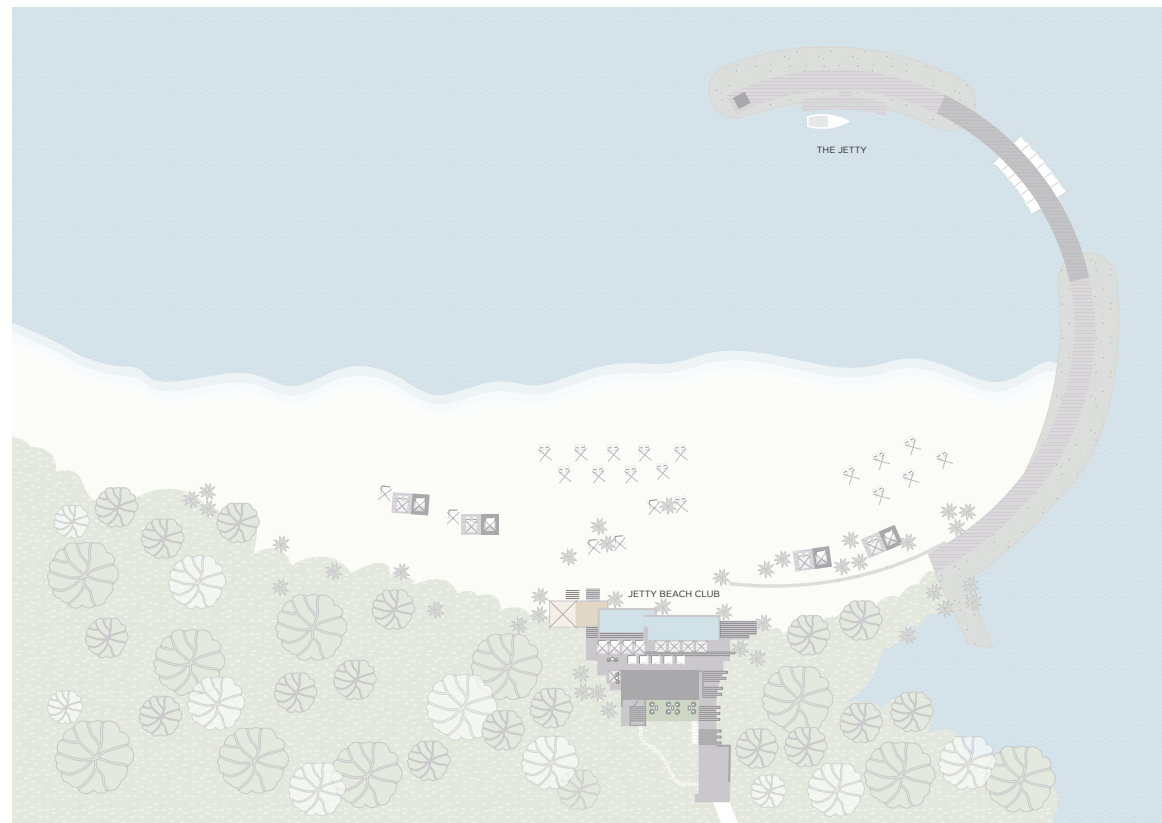

## JETTY BEACH CLUB FLOORPLAN

